



The Gazette of Meghalaya

PUBLISHED BY AUTHORITY

No. 15

Shillong, Thursday, April 10, 2025

20th Chaitra, 1947 (S. E.)

Separate paging is given on this part in order that it may be filed as a separate compilation.

PART-IIA

GOVERNMENT OF MEGHALAYA

NOTIFICATIONS

The 10th March, 2025.

No.FOR.17/2013/Pt-II/323. - In accordance with the provisions of Section 36 C of the Wild Life (Protection) Act, 1972 (as amended up to 2006), the Governor of Meghalaya is pleased to declare Dandarigre Reserve, in West Garo Hills District as a Community Reserve to be known as the "**Dandarigre Community Reserve**" with immediate effect as per the schedule of boundaries indicated below:-

Schedule of Boundaries:-

The boundary starts from **Point No. 1** at 25°55 ' 19.09", 90°22 ' 59.2", having Areca nut plantation of Mr. Jolding Sangma on the left, then it proceeds in a South West direction to **Point No. 2** at 25°55 ' 16.41", 90°22 ' 58.98", having Areca nut plantation of Mr. Jolding Sangma on the left, then it proceeds in a South West direction to **Point No. 3** at 25°55 ' 14.86", 90°22' 56.74", having Areca nut plantation of Mr. Jolding Sangma on the left, then proceeds further in a South West direction till it reaches **Point No. 4** at 25°55 ' 13.63", 90°22 ' 54.22", having Areca nut plantation of Mr. Jolding Sangma on the left, then it proceeds in a South West direction to **Point No. 5** at 25°55 ' 11.21", 90°22 ' 53.23", having Rubber plantation of Mr. Kinjing Sangma on the left. From the **Point No. 5** the boundary proceeds in a South West direction till it reaches **Point No.6** at 25°55 ' 10.02", 90°22 ' 52", having Rubber plantation of Mr. Kinjing Sangma on the left, then it proceeds in a North West direction till it reaches **Point No. 7** at 25°55 ' 11.77", 90°22 ' 49.8", having Rubber plantation of Mr. Kinjing Sangma on the left, then it further proceeds in a North West direction till it reaches **Point No. 8** at 25°55 ' 13.77", 90°22 ' 48.27", having Rubber plantation of Mr. Kinjing Sangma on the left. From the **Point No. 8**, the boundary proceeds in a South West direction upto **Point No. 9** at 25°55 ' 12.2", 90°22 ' 46.09", having Rubber plantation of Mr. Kinjing Sangma on the left, then it proceeds in a North West direction till it reaches **Point No. 10** at 25°55 ' 12.95", 90°22 ' 44.56", having Areca nut plantation of Bahanangre Village on the left.

From there it proceeds in a North West direction till it reaches **Point No. 11** at 25°55 ' 15.64", 90°22 ' 44.42", having Areca nut plantation of Bahanangre Village on the left, and then it proceeds in a North West direction till **Point No. 12** at 25°55 ' 18.32 " , 90°22 ' 44.33 " , having Areca nut plantation of Bahanangre Village on the left, then it proceeds in a North East direction to **Point No. 13** at 25°55 ' 20.87", 90°22 ' 44.81", having Areca nut plantation of Bahanangre Village on the left., then proceeds further in a North East direction till it reaches **Point No. 14** at 25°55 ' 23.38", 90°22 ' 45.23", having Areca nut plantation of Bahanangre Village on the left,

then it proceeds in a North East direction to **Point No. 15** at 25°55 ' 24.6", 90°22 '47.79", having Areca nut plantation of Bahanangre Village on the left. From the **Point No. 15**, the boundary proceeds in a North East direction till it reaches **Point No. 16** at 25°55 ' 25.44", 90°22 ' 50.61", having Areca nut plantation of Bahanangre Village on the left., then it proceeds in a North East direction till it reaches **Point No. 17** at 25°55 ' 26.74", 90°22 ' 53.13", having Areca nut plantation of Bahanangre Village on the left., then it further proceeds in a South East direction till it reaches **Point No. 18** at 25°55 ' 25.5", 90°22 ' 55.56", having Areca nut plantation of Bahanangre Village on the left. From the **Point No. 18**, the boundary proceeds in a South East direction upto **Point No. 19** at 25°55 ' 24.15", 90°22 '57.76", having Areca nut plantation of Bahanangre Village on the left, then it proceeds in a South East direction till it reaches **Point No. 20** at 25°55 ' 22.49", 90°22 ' 59.78", having Areca nut plantation of Bahanangre Village on the left.

AREA: 15.03 hac. (Approximately)

No.FOR.17/2013/Pt-II/323-A. - In exercise of the powers conferred under Section 36 D of the Wild Life (Protection) Act, 1972 (as amended upto 2006), the Governor of Meghalaya is pleased to constitute the Management Committee for the "**Dandarigre Community Reserve**" consisting of the following members: -

1. Shri Kenjang Sangma - Chairman
2. Shri Boni Marak - Member
3. Shri Monsing Marak - Member
4. Smti. Prejina Sangma - Member
5. Shri Gopon Sangma - Member
6. The Divisional Forest Officer, East and West Garo Hills, Wildlife Division, - Member Secretary
Tura or his/her nominee not below the rank of Forester-I.

The Committee shall elect a chairman who shall also be the Honorary Wildlife Warden of the Community Reserve.

SAMPATH KUMAR,

Principal Secretary to the Government of Meghalaya,
Forest & Environment Department.

The 10th March, 2025.

No.FOR.17/2013/Pt-II/324. - In accordance with the provisions of Section 36 C of the Wild Life (Protection) Act, 1972 (as amended up to 2006), the Governor of Meghalaya is pleased to declare Upper Chisikgre, in West Garo Hills District as a Community Reserve to be known as the "**Upper Chisikgre Community Reserve**" with immediate effect as per the schedule of boundaries indicated below:-

Schedule of Boundaries:-

The boundary starts from **Point No. 1** at 25°56 ' 3.28", 90°23 ' 30.8", having Areca nut plantation of Mr. Singjang Sangma on the left., then it proceeds in a North East direction to **Point No. 2** at 25°56 ' 5.28", 90°23 ' 32.2" having Areca nut plantation of Mr. Singjang Sangma on the left, then it proceeds in a North East direction to **Point No. 3** at, 25°56 ' 7.6", 90°23 ' 32.64", having Areca nut plantation of Mr. Singjang Sangma on the left, then proceeds further in a North West direction till it reaches **Point No. 4** at 25°56 ' 10.01", 90°23 ' 31.96", having Areca nut plantation of Mr. Singjang Sangma on the left, then it proceeds in a North East direction to **Point No. 5** at 25°56 ' 12.39", 90°23 ' 32.42", having Areca nut plantation of Mr. Wilban Marak on the left. From the **Point No. 5**, the boundary proceeds in a North East direction till it reaches Point No.6 at 25°56 ' 13.83", 90°23 ' 34.5", having Areca nut plantation of Mr. Wilban Marak on the left, then it proceeds in a South East direction till it reaches **Point No. 7** at 25°56 ' 12.65", 90°23 ' 36.54", having Areca nut plantation of Mr. Wilban Marak on the left, then it further proceeds in a South East direction till it reaches **Point No. 8** at 25°56 ' 10.73", 90°23 ' 37.75", having Areca nut plantation of Mr. Wilban Marak on the left. From the **Point No. 8**, the boundary proceeds in a South East direction upto **Point No. 9** at 25°56' 8.29", 90°23 ' 38", having Areca nut plantation of Mr. Nengjak Sangma on the left, then it proceeds in a South East direction till it reaches **Point No. 10** at 25°56 ' 5.84", 90°23 ' 38.37", having Areca nut plantation of Mr. Nengjak Sangma on the left.

From there it proceeds in a South East direction till it reaches **Point No. 11** at 25°56 ' 3.64", 90°23 ' 39.02", having Areca nut plantation of Mr. Nengjak Sangma on the left, and then it proceeds in a South West direction till **Point No. 12** at 25°56 ' 1.26", 90°23 ' 38.6", having Areca nut plantation of Mr. Dolgo Marak on the left, then it proceeds in a South West direction to **Point No. 13** at 25°55 ' 58.97", 90°23 ' 38.27", having Rubber plantation of Mr. Dolgo Marak on the left, then proceeds further in a South West direction till it reaches **Point No. 14** at 25°55 ' 56.74", 90°23 ' 38.18", having Rubber plantation of Mr. Dolgo Marak on the left, then it proceeds in a South West direction to **Point No. 15** at 25°55 ' 54.48", 90°23 ' 37.57", having Areca nut plantation of Mr. Stet Sangma on the left. From the **Point No. 15**, the boundary proceeds in a South West direction till it reaches **Point No. 16** at 25°55 ' 53.21", 90°23 ' 35.32", having Areca nut plantation of Mr. Stet Sangma on the left, then it proceeds in a North West direction till it reaches **Point No. 17** at 25°55' 54.83", 90°23 ' 34.31", having Areca nut plantation of Mr. Jangan Sangma on the left, then it further proceeds in a North West direction till it reaches **Point No. 18** at 25°55 ' 55.76", 90°23 ' 32.36", having Areca nut plantation of Mr. Jangan Sangma on the left. From the **Point No. 18**, the boundary proceeds in a North West direction upto **Point No. 19** at 25°55 ' 58.12", 90°23 ' 31.77", having Areca nut plantation of Mr. Jangan Sangma on the left, then it proceeds in a North West direction till it reaches **Point No. 20** at 25°56 ' 0.25", 90°23 ' 30.9", having Areca nut plantation of Mr. Jangan Sangma on the left.

AREA: 10.37 hac. (Approximately).

No.FOR.17/2013/Pt-II/324-A. - In exercise of the powers conferred under Section 36 D of the Wild Life (Protection) Act, 1972 (as amended upto 2006), the Governor of Meghalaya is pleased to constitute the Management Committee for the "**Upper Chisikgre Community Reserve**" consisting of the following members:-

- | | | | | |
|----|---|---|----------|-----------|
| 1. | Shri Donjang Sangma | - | Chairman | |
| 2. | Shri Walnut Marak | - | Member | |
| 3. | Smti. Denosil Sangma | - | Member | |
| 4. | Shri Jemberth Sangma | - | Member | |
| 5. | Shri Satnang Marak | - | Member | |
| 6. | The Divisional Forest Officer, East and West Garo Hills, Wildlife Division, Tura or his/her nominee not below the rank of Forester-I. | - | Member | Secretary |

The Committee shall elect a chairman who shall also be the Honorary Wildlife Warden of the Community Reserve.

SAMPATH KUMAR,

Principal Secretary to the Government of Meghalaya,
Forest & Environment Department.

The 10th March, 2025.

No.FOR.17/2013/Pt-II/325. - In accordance with the provisions of Section 36 C of the Wild Life (Protection) Act, 1972 (as amended up to 2006), the Governor of Meghalaya is pleased to declare Andalsikgre Reserve, in West Garo Hills District as a Community Reserve to be known as the "**Andalsikgre Community Reserve**" with immediate effect as per the schedule of boundaries indicated below:-

Schedule of Boundaries:-

The boundary starts from **Point No. 1** at 25°52 ' 10.9", 90°22 ' 5.81", having Rubber and areca nut plantation of Mr. Mengson Marak on the left, then it proceeds in a North West direction to **Point No. 2** at 25°52' 12.76", 90°22 ' 3.15 " , having Rubber and areca nut plantation of Mr. Mengson Marak on the left., then it proceeds in a North West direction to **Point No. 3** at 25°52 ' 16", 90°22 ' 2.39", having Rubber and Areca nut plantation of Mr. Mengson Marak on the left., then proceeds further in a North West direction till it reaches **Point No. 4** at 25°52 ' 17.92", 90°22 ' 0.28", having Areca nut plantation of Mr. Deul Marak on the left, then it proceeds in a North East direction to **Point No. 5** at 25°52 ' 20.86", 90°22 ' 1.31", having Areca nut plantation of Mr. Deul Marak on the left. From the **Point No. 5**, the boundary proceeds in a North East direction till it reaches **Point No. 6** at 25°52 ' 22.37", 90°22 ' 1.55", having Farmland of Mr. Nakbird Marak on the left, then it proceeds in a North East direction till it reaches **Point No. 7** at 25°52 ' 22.6", 90°22 ' 4.97", having Farmland of Mr. Nakbird Marak on the left, then it further proceeds in a North East direction till it reaches **Point No. 8** at 25°52 ' 24.98", 90°22 ' 5.56", having Areca nut and pineapple plantation of Mr. Nengot Marak on the left.. From the **Point No. 8**, the boundary proceeds in a North East direction upto **Point No. 9** at 25°52 ' 28.15", 90°22 ' 5.89", having Areca nut and pineapple plantation of Mr. Nengot Marak on the left, then it proceeds in a North East direction till it reaches **Point No. 10** at 25°52 ' 31.44", 90°22 ' 6.15", having Areca nut and pineapple plantation of Mr. Nengot Marak on the left.

From there it proceeds in a North East direction till it reaches **Point No. 11** at 25°52 ' 34.57", 90°22 '6.17", having Reserve of Mr. Watnang Marak on the left, and then it proceeds in a South East direction till **Point No, 12** at 25°52 ' 33.68", 90°22 ' 8.85", having Reserve of Mr. Watnang Marak on the left, then it proceeds in a South East direction to **Point No. 13** at 25°52 ' 30.58", 90°22 ' 9.94", having Village Road on the left, then

proceeds further in a South East direction till it reaches **Point No. 14** at 25°52 ' 27.61", 90°22 ' 11.12", having Village Road on the left, then it proceeds in a South East direction to **Point No. 15** at 25°52 '24.72", 90°22 ' 11.56", having Village Road on the left. From the **Point No. 15**, the boundary proceeds in a South East direction till it reaches **Point No.16** at 25°52 ' 21.51", 90°22 ' 12.27", having Village Road on the left, then it proceeds in a South East direction till it reaches **Point No. 17** at 25°52 ' 18.3", 90°22 ' 12.32", having Arecanut plantation of Mr. Sangam Sangma on the left, then it further proceeds in a South East direction till it reaches **Point No. 18** at 25°52 ' 15", 90°22 ' 12.6", having Areca nut plantation of Mr. Sangam Sangma on the left. From the **Point No. 18**, the boundary proceeds in a South West direction upto **Point No. 19** at 25°52' 12", 90°22 ' 12.39", having Areca nut plantation of Mr. Sangam Sangma on the left, then it proceeds in a South West direction till it reaches **Point No. 20** at 25°52 ' 10.27", 90°22 ' 10.3", having Areca nut plantation of Mr. Sangam Sangma on the left.

AREA: 15.46 hac. (Approximately).

No.FOR.17/2013/Pt-II/325-A. - In exercise of the powers conferred under Section 36 D of the Wild Life (Protection) Act, 1972 (as amended upto 2006), the Governor of Meghalaya is pleased to constitute the Management Committee for the "**Andalsikgre Community Reserve**" consisting of the following members:-

- | | | |
|--|---|------------------|
| 1. Shri Nikjeng Sangma | - | Chairman |
| 2. Shri Ringsu Sangma | - | Member |
| 3. Smti. Nengjak Marak | - | Member |
| 4. Smti. Samilla Marak | - | Member |
| 5. Shri Watman Marak | - | Member |
| 6. The Divisional Forest Officer, East and West Garo Hills, Wildlife Division, Tura or his/her nominee not below the rank of Forester-I. | - | Member Secretary |

The Committee shall elect a chairman who shall also be the Honorary Wildlife Warden of the Community Reserve.

SAMPATH KUMAR,

Principal Secretary to the Government of Meghalaya,
Forest & Environment Department.

The 10th March, 2025.

No.FOR.17/2013/Pt-II/326. - In accordance with the provisions of Section 36 C of the Wild Life (Protection) Act, 1972 (as amended up to 2006), the Governor of Meghalaya is pleased to declare Ravagre Reserve, in West Garo Hills District as a Community Reserve to be known as the "**Ravagre Community Reserve**" with immediate effect as per the schedule of boundaries indicated below:-

Schedule of Boundaries:-

The boundary starts from **Point No. 1** at 25°56 ' 58.39 " , 90°22 ' 11.17 " , having Reserve of Rangtapgre on the left, then it proceeds in a North East direction to **Point No. 2** at 25°57 ' 0.48", 90°22 '11.38", having Reserve of Rangtapgre on the left, then it proceeds in a North East direction to **Point No. 3** at 25°57 ' 0.55", 90°22 ' 13.05 " , having Arecanut plantation of Nangran Marak on the left, then proceeds further in a North East direction till it reaches **Point No. 4** at 25°57 ' 1.26", 90°22 ' 15.03". having Areca nut plantation of Nangran Marak on the left, then it proceeds in a North East direction to **Point No. 5** at 25°57 ' 2.44", 90°22 ' 16.94", having Areca nut plantation of Redmi Marak on the left. From the **Point No. 5**, the boundary proceeds in a South East direction till it reaches **Point No. 6** at 25°57 ' 1.97", 90°22 ' 18.77", having Areca nut plantation of Redmi Marak on the left, then it proceeds in a South East direction till it reaches **Point No. 7** at 25°57 ' 0.42", 90°22 ' 19.54", having Areca nut plantation of Thaljen Sangma on the left, then it further proceeds in a South East direction till it reaches **Point No. 8** at 25°56 ' 58.92", 90°22 ' 20.05", having Areca nut plantation of Thaljen Sangma on the left. From the **Point No. 8**, the boundary proceeds in a South East direction upto **Point No. 9** at 25°56 ' 56.92", 90°22 ' 20.28", having Areca nut plantation of Forgan Marak on the left, then it proceeds in a South East direction till it reaches **Point No. 10** at 25°56 ' 55.34", 90°22 ' 20.84", having Areca nut plantation of Forgan Marak on the left.

From there it proceeds in a South West direction till it reaches **Point No. 11** at 25°56 ' 54.54", 90°22 ' 18.98", having Areca nut plantation of Kalban Marak on the left and then it proceeds in a North West direction till **Point No. 12** at 25°56 ' 54.63", 90°22 ' 16.92", having Areca nut plantation of Kalban Marak on the left then it proceeds in a North East direction to **Point No. 13** at 25°56 ' 55.63 " , 90°22 ' 18.09 " , having Areca nut plantation of Kalban Marak on the left, then proceeds further in a North West direction till it reaches Point No. 14 at 25°56 ' 55.74", 90°22 ' 16.46", having Areca nut plantation of Nelson Sangma on the left, then it proceeds in a South West direction to **Point No. 15** at 25°56 ' 54.62", 90°22 ' 14.98", having Areca nut plantation of Nelson Sangma on the left. From the **Point No. 15**, the boundary proceeds in a North West direction till it reaches **Point No.16** at 25°56 ' 55.72", 90°22 ' 13.08", having Areca nut plantation of Nelson Sangma on the left, then it proceeds in a South West direction till it reaches Point **No, 17** at 25°56 ' 54.2", 90°22 ' 11.82", having Areca nut plantation of Nelson Sangma on the left, then it further proceeds in a South West direction till it reaches **Point No. 18** at 25°56 ' 52.21", 90°22 ' 11.25", having Areca nut plantation of Nelson Sangma on the left. From the **Point No. 18**, the boundary proceeds in a North West direction upto **Point No. 19** at 25°56 ' 53.57", 90°22 ' 10.48", having Areca nut plantation of Nelson Sangma on the left, then it proceeds in a North East direction till it reaches **Point No. 20** at 25°56 '55.56", 90°22 ' 11.14", having Areca nut plantation of Nelson Sangma on the left.

AREA: 5.28 hac. (Approximately).

No.FOR.17/2013/Pt-II/326-A. - In exercise of the powers conferred under Section 36 D of the Wild Life (Protection) Act, 1972 (as amended upto 2006), the Governor of Meghalaya is pleased to constitute the Management Committee for the "**Ravagre Community Reserve**" consisting of the following members:-

1. Shri Metil Ch. Sangma - Chairman
2. Shri Ronen Marak - Member
3. Shri Emanuel B. Marak - Member
4. Shri Krimson Sangma - Member
5. Shri Minen Sangma - Member
6. The Divisional Forest Officer, East and West Garo Hills, Wildlife Division, Tura or his/her nominee not below the rank of Forester-I. - Member Secretary

The Committee shall elect a chairman who shall also be the Honorary Wildlife Warden of the Community Reserve.

SAMPATH KUMAR,

Principal Secretary to the Government of Meghalaya,
Forest & Environment Department.

The 10th March, 2025.

No.FOR.17/2013/Pt-II/327. - In accordance with the provisions of Section 36 C of the Wild Life (Protection) Act, 1972 (as amended up to 2006), the Governor of Meghalaya is pleased to declare Katonggre Reserve, in West Garo Hills District as a Community Reserve to be known as the "**Katonggre Community Reserve**" with immediate effect as per the schedule of boundaries indicated below:-

Schedule of Boundaries:-

The boundary starts from **Point No. 1** at 25°56 ' 0.37", 90° 19 ' 27.72", having Rubber plantation of Sanang Sangma on the left, then it proceed in a South West direction to **Point No. 2** at 25°55 ' 58.64", 90° 19 ' 26.7", having Rubber plantation of Sanang Sangma on the left, then it proceeds in a South West direction to **Point No. 3** at 25°55 ' 57.63", 90° 19 ' 24.95", having Rubber plantation of Sanang Sangma on the left, then proceeds further in a North West direction till it reaches **Point No. 4** at 25°55 ' 58.15", 90°19 ' 22.82", having Rubber plantation of Sanang Sangma on the left, then it proceeds in a North West direction to **Point No. 5** at 25°55 ' 59.69", 90°19 ' 21.56", having Rubber plantation of Sanang Sangma on the left. From the **Point No. 5**, the boundary proceeds in a North West direction till it reaches **Point No. 6** at 25°56 ' 1.32", 90°19 ' 20.48", having Rubber plantation of Sanang Sangma on the left, then it proceeds in a North East direction till it reaches **Point No. 7** at 25°56 ' 3.2", 90°19 ' 20.72", having Areca nut plantation of Shining Momin on the left, then it further proceeds in a North East direction till it reaches **Point No. 8** at 25°56 ' 4.97", 90° 19 ' 21.44", having Areca nut plantation of Shining Momin on the left. From the **Point No. 8**, the boundary proceeds in a North East direction upto **Point No. 9** at 25°56 ' 5.81", 90°19 ' 23.39", having Areca nut plantation of Shining Momin on the left, then it proceeds in a North West direction till it reaches **Point No. 10** at 25°56 7.73", 90° 19 ' 23.14", having Areca nut plantation of Shining Momin on the left.

From there it proceeds in a North West direction till it reaches **Point No. 11** at 25°56 ' 9.01", 90°19 ' 21.67", having Areca nut plantation of Shining Momin on the left, and then it proceeds in a North East direction till **Point No. 12** at 25°56 ' 10.83", 90° 19 ' 21.71", having Areca nut plantation of Shining Momin on the left, then it proceeds in a South East direction to **Point No. 13** at 25°56 ' 10.72", 90°19 ' 23.94", having Areca nut plantation of Jongga Sangma on the left, then proceeds further in a South East direction till it reaches **Point No. 14** at 25°56 ' 10.51", 90° 19 ' 26.17", having Areca nut plantation of Jongga Sangma on the left, then it proceeds in a South East direction to **Point No. 15** at 25°56 ' 9.72", 90°19 ' 28.16", having Areca nut plantation of Jongga Sangma on the left. From the **Point No. 15**, the boundary proceeds in a North East direction till it reaches **Point No.16** at 25°56 ' 10.01", 90°19 ' 30.37", having Areca nut plantation of Sengman Marak on the left, then it proceeds in a South East direction till it reaches **Point No. 17** at 25°56 ' 8.5", 90°19 ' 31.15", having Areca nut plantation of Sengman Marak on the left, then it further proceeds in a South West direction till it reaches **Point No. 18** at 25°56 ' 6.57", 90°19 ' 30.68", having Areca nut plantation of Ambi Marak on the left. From the **Point No. 18**, the boundary proceeds in a South West direction upto **Point No. 19** at 25°56 ' 4.65", 90°19 ' 29.98", having Areca nut plantation of Ambi Marak on the left, then it proceeds in a South West direction till it reaches **Point No. 20** at 25°56 ' 2.7", 90°19 ' 29.54", having Areca nut plantation of Jaban Marak on the left.

AREA: 8.36 hac. (Approximately).

No.FOR.17/2013/Pt-II/327-A. - In exercise of the powers conferred under Section 36 D of the Wild Life (Protection) Act, 1972 (as amended upto 2006), the Governor of Meghalaya is pleased to constitute the Management Committee for the "**Katonggre Community Reserve**" consisting of the following members:-

1.	Shri Obison A. Sangma	-	Chairman
2.	Shri Oliver A. Sangma	-	Member
3.	Shri Malsin K. Sangma	-	Member
4.	Smti. Bebeanna Ch. Sangma	-	Member
5.	Shri Tujung R. Marak	-	Member
6.	The Divisional Forest Officer, East and West Garo Hills, Wildlife Division, Tura or his/her nominee not below the rank of Forester-I.	-	Member Secretary

The Committee shall elect a chairman who shall also be the Honorary Wildlife Warden of the Community Reserve.

SAMPATH KUMAR,

Principal Secretary to the Government of Meghalaya,
Forest & Environment Department.

The 10th March, 2025.

No.FOR.17/2013/Pt-II/328. - In accordance with the provisions of Section 36 C of the Wild Life (Protection) Act, 1972 (as amended up to 2006), the Governor of Meghalaya is pleased to declare Upper Ravagre Reserve in West Garo Hills District as a Community Reserve to be known as the "**Upper Ravagre Community Reserve**" with immediate effect as per the schedule of boundaries indicated below:-

Schedule of Boundaries:-

The boundary starts from **Point No. 1** at 25°58' 5.38", 90°22' 51.49", having Areca nut plantation of Butas Marak on the left, then it proceeds in a South West direction to **Point No. 2** at 25°58' 4.33", 90°22' 50.39", having Areca nut plantation of Butas Marak on the left, then it proceeds in a South West direction to **Point No. 3** at 25°58' 3.52", 90°22' 49.09", having Areca nut plantation of Butas Marak on the left, then proceeds further in a South West direction till it reaches **Point No. 4** at 25°58' 2.29", 90°22' 48.22", having Reserve of Arjen Sangma on the left, then it proceeds in a South West direction to **Point No. 5** at 25°58' 1.72", 90°22' 46.79", having Areca nut plantation of Batme Sangma on the left. From the **Point No. 5**, the boundary proceeds in a South West direction till it reaches **Point No. 6** at 25°58' 1.17", 90°22' 45.31", having Areca nut plantation of Krebinath Sangma on the left, then it proceeds in a South West direction till it reaches **Point No. 7** at 25°57' 59.79", 90°22' 44.8", having Areca nut plantation of Krebinath Sangma on the left, then it further proceeds in a South West direction till it reaches **Point No. 8** at 25°57' 59.56", 90°22' 43.45", having Rubber plantation of Charming Sangma on the left. From the **Point No. 8**, the boundary proceeds in a North West direction upto **Point No. 9** at 25°58' 0.7", 90°22' 43.12", having Rubber plantation of Charming Sangma on the left, then it proceeds in a North West direction till it reaches **Point No. 10** at 25°58' 2.16", 90°22' 42.91", having Rubber plantation of Krislina Marak on the left.

From there it proceeds in a North West direction till it reaches **Point No. 11** at 25°58' 3.56", 90°22' 42.64", having Rubber plantation of Krislina Marak on the left and then it proceeds in a North East direction till **Point No. 12** at 25°58' 4.8", 90°22' 43.51", having Rubber plantation of Krishna Marak on the left, then it proceeds in a North East direction to **Point No. 13** at 25°58' 5.89", 90°22' 44.58", having Areca nut plantation of Jejen Marak on the left, then proceeds further in a North East direction till it reaches **Point No. 14** at 25°58' 7.11", 90°22' 45.43", having Areca nut plantation of Jejen Marak on the left, then it proceeds in a North East direction to **Point No. 15** at 25°58' 8.46", 90°22' 46.12", having Areca nut plantation of Jejen Marak on the left. From the **Point No. 15** the boundary proceeds in a North East direction till it reaches **Point No. 16** at 25°58' 9.5", 90°22' 46.95", having Areca nut plantation of Jejen Marak on the left, then it proceeds in a North East direction till it reaches **Point No. 17** at 25°58' 9.93", 90°22' 48.56", having Areca nut plantation of Abinash Sangma on the left, then it further proceeds in a South East direction till it reaches **Point No. 18** at 25°58' 8.97", 90°22' 49.69", having Rubber plantation of Arun Sangma on the left. From the **Point No. 18**, the boundary proceeds in a South East direction upto **Point No. 19** at 25°58' 8.52", 90°22' 51.15", having Rubber plantation of Arun Sangma on the left, then it proceeds in a South East direction till it reaches **Point No. 20** at 25°58' 7.4", 90°22' 52.07", having Rubber plantation of Arun Sangma on the left.

AREA: 4.52 hac. (Approximately).

No.FOR.17/2013/Pt-II/328-A. - In exercise of the powers conferred under Section 36 D of the Wild Life (Protection) Act, 1972 (as amended upto 2006), the Governor of Meghalaya is pleased to constitute the Management Committee for the "**Upper Ravagre Community Reserve**" consisting of the following members:-

1. Shri Polen Marak - Chairman
2. Shri Akash Sangma - Member
3. Shri Namson Marak - Member
4. Shri Albert Marak - Member
5. Shri Holendro Marak - Member
6. The Divisional Forest Officer, East and West Garo Hills, Wildlife Division, - Member Secretary
Tura or his/her nominee not below the rank of Forester-I.

The Committee shall elect a chairman who shall also be the Honorary Wildlife Warden of the Community Reserve.

SAMPATH KUMAR,

Principal Secretary to the Government of Meghalaya,
Forest & Environment Department.

The 10th March, 2025.

No.FOR.17/2013/Pt-II/329. - In accordance with the provisions of Section 36 C of the Wild Life (Protection) Act, 1972 (as amended upto 2006), the Governor of Meghalaya is pleased to declare Dobakkol Reserve in West Garo Hills District, as a Community Reserve to be known as the "**Dobakkol Community Reserve**" with immediate effect as per the schedule of boundaries indicated below:-

Schedule of Boundaries:-

The boundary starts from **Point No. 1** at 25°41 '41.75", 90° 11 ' 58.18 " , having Siken's paddy field , then it proceeds in a North East direction to **Point No. 2** at 25°41 ' 43.53", 90° 11 ' 58.71", having Ratden's Paddy field., then it proceeds in a North East direction to **Point No. 3** at,25°41 ' 44.89", 90° 11' 59.82", having Ratden's Paddy field , then proceeds further in a North East direction till it reaches **Point No. 4** at 25°41 ' 46.3", 90°12 ' 0.96", having Setnak Sangma's Rubber plantation, then it proceeds in a North East direction to **Point No. 5** at 25°41' 46.34", 90° 12 ' 3", having Setnak Sangma's Rubber plantation. From the **Point No. 5**, the boundary proceeds in a North East direction till it reaches **Point No.6** at 25°41 ' 46.53 " , 90°12' 4.86", having Setnak Sangma's Rubber plantation, then it proceeds in a South East direction till it reaches **Point No. 7** at 25°41 ' 44.74", 90°12 ' 5.36", having Setnak Sangma's Rubber plantation, then it further proceeds in a South East direction till it reaches **Point No. 8** at 25°41 ' 42.92", 90°12 ' 5.9", having Setnak Sangma's Rubber plantation. From the **Point No. 8**, the boundary proceeds in a South East direction upto **Point No. 9** at 25°41 ' 41.02", 90°12'6.15", having Setnak Sangma's Rubber plantation, then it proceeds in a South West

direction till it reaches **Point No. 10** at 25°41 '39.33", 90°12 ' 5.55", having Setnak Sangma's Rubber plantation.

From there it proceeds in a South West direction till it reaches **Point No. 11** at 25°41' 37.52", 90°12 ' 5.31", having Setnak Sangma's rubber plantation and then it proceeds in a South East direction till **Point No. 12** at 25°41 ' 35.59 " , 90°12 ' 5.59", having Setnak Sangma's Rubber plantation, then it proceeds in a South West direction to **Point No. 13** at 25°41 ' 33.8", 90°12 ' 5.13", having Setnak Sangma's Rubber plantation, then proceeds further in a South West direction till it reaches **Point No. 14** at 25°41 ' 33.59", 90°12 ' 3.45", having Setnak Sangma's Rubber plantation, then it proceeds in a North West direction to **Point No. 15** at 25°41 ' 35.24", 90°12 ' 2.32", having Polpol's Cashewnut plantation. From the **Point No. 15**, the boundary proceeds in a North West direction till it reaches **Point No.16** at 25°41 ' 35.82 " , 90°12 ' 0.36", having Dalben's Cashew nut plantation, then it proceeds in a South West direction till it reaches **Point No. 17** at 25°41 ' 35.77", 90° 11' 58.28", having Dalben's Cashewnut plantation, then it further proceeds in a South West direction till it reaches **Point No. 18** at 25°41 ' 35.53", 90°11' 56.46", having Hamilton's Bamboo plantation. From the **Point No. 18**, the boundary proceeds in a North East direction upto **Point No. 19** at 25°41 ' 37.31", 90°11' 56.79", having Dalben's pond, then it proceeds in a North East direction till it reaches **Point No. 20** at 25°41 ' 39.23", 90°11 ' 57.06", having Jatnen's Paddy field.

AREA: 7.47 hac. (Approximately).

No.FOR.17/2013/Pt-II/329-A. - In exercise of the powers conferred under Section 36 D of the Wild Life (Protection) Act, 1972 (as amended upto 2006), the Governor of Meghalaya is pleased to constitute the Management Committee for the "**Dobakkol Community Reserve**" consisting of the following members:-

1. Samuel M. Marak - Chairman
2. Tengrak Sangma - Member
3. Nildosh Ch. Marak - Member
4. Arnith M. Sangma - Member
5. Setnak Sangma - Member
6. The Divisional Forest Officer, East and West Garo Hills, Wildlife Division, Tura or his/her nominee not below the rank of Forester-I. - Member Secretary

The Committee shall elect a chairman who shall also be the Honorary Wildlife Warden of the Community Reserve.

SAMPATH KUMAR,

Principal Secretary to the Government of Meghalaya,
Forest & Environment Department.

The 10th March, 2025.

No.FOR.17/2013/Pt-II/330. - In accordance with the provisions of Section 36 C of the Wild Life (Protection) Act, 1972 (as amended up to 2006), the Governor of Meghalaya is pleased to declare Bawegre Baljek Reserve in West Garo Hills District as a Community Reserve to be known as the "**Bawegre Baljek Community Reserve**" with immediate effect as per the schedule of boundaries indicated below:-

Schedule of Boundaries:-

The boundary starts from **Point No. 1** at 25°40 ' 16.25", 90°20' 47.75", having Arecanut plantation of Repseny T. Sangma on the left side, then it proceeds in a North East direction to **Point No. 2** at 25°40 ' 17.39", 90°20 ' 49.77", having Arecanut plantation of Clinbirth D. Sangma on the left side, then it proceeds in a South East direction to **Point No. 3** at 25°40 ' 17.04", 90°20 ' 51.99", having Arecanut plantation of Harmi Momin and stream on the left side, then proceeds further in a South East direction till it reaches **Point No. 4** at 25°40' 15.39", 90°20 ' 53.55", having Arecanut plantation of Jasinta B. Marak on the left side, then it proceeds in a South East direction to **Point No. 5** at 25°40 ' 14.15", 90°20 ' 55.49", having Areca nut plantation of Bimsing N. Sangma and Rongka Stream on the left side. From the **Point No. 5**, the boundary proceeds in a South West direction till it reaches **Point No.6** at 25°40 ' 12.6", 90°20 ' 54.51", having Rongka Stream on the left side, then it proceeds in a South East direction till it reaches **Point No. 7** at 25°40 ' 10.76", 90°20 ' 55.71", having Rongka Stream on the left side, then it further proceeds in a South West direction till it reaches **Point No. 8** at 25°40 ' 8.82", 90°20' 54.79", having Sekon stream on the left side. From the **Point No. 8**, the boundary proceeds in a South West direction upto **Point No. 9** at 25°40 ' 7.84", 90°20 ' 52.62", having Baljek airport boundary on the left side till point 10, then it proceeds in a South West direction till it reaches **Point No. 10** at 25°40' 7.12", 90°20' 50.3", having Baljek airport boundary on the left side.

From there it proceeds in a North West direction till it reaches **Point No. 11** at 25°40 ' 7.79", 90°20 ' 48.36", having Paddy field of Genaram B. Marak on the left side and then it proceeds in a South West direction till **Point No. 12** at 25°40 ' 5.92 ", 90°20 ' 47.04", having Paddy field of Tenison T. Sangma on the left side, then it proceeds in a South West direction to **Point No. 13** at 25°40 ' 5.2", 90°20 ' 45.09", having Paddy field of Tenison T. Sangma on the left side, then proceeds further in a North West direction till it reaches **Point No. 14** at 25°40 ' 5.26", 90°20' 43.33", having Paddy field of Anton Marak on the left side, then it proceeds in a North East direction to **Point No. 15** at 25°40 ' 6.78" , 90°20 ' 43.91", having Paddy field of Anton Marak on the left side. From the **Point No. 15**, the boundary proceeds in a North West direction till it reaches **Point No. 16** at 25°40 ' 7.8", 90°20 ' 42.75", having Paddy field of Anton Marak on the left side, then it proceeds in a North West direction till it reaches **Point No. 17** at 25°40 ' 9.96", 90°20' 42.44", having Faddy field of Anton Marak on the left side, then it further proceeds in a North East direction till it reaches **Point No. 18** at 25°40' 12", 90°20 ' 42.98", having Baljek stream on the left side From the **Point No. 18**, the boundary proceeds in a North East direction upto **Point No. 19** at 25°40 ' 13.35", 90°20' 43.26", having Paddy field of Mojen B. Marak on the left side, then it proceeds in a North East direction till it reaches **Point No. 20** at 25°40 ' 14.76", 90°20 ' 45.01", having Arecanut and citrus plantation of Repseny T. Sangma on the left side.

AREA: 9.47 hac. (Approximately).

No.FOR.17/2013/Pt-II/330-A. - In exercise of the powers conferred under Section 36 D of the Wild Life (Protection) Act, 1972 (as amended upto 2006), the Governor of Meghalaya is pleased to constitute the Management Committee for the "**Bawegre Baljek Community Reserve**" consisting of the following members:-

1. Shri Jimbirth D. Sangma - Chairman
2. Prinaballa B Marak - Member
3. Shri Panseng B. Marak - Member
4. Windfillar T. Sangma - Member
5. Smti. Nosimchi B. Marak - Member
6. The Divisional Forest Officer, East and West Garo Hills, Wildlife Division, Tura or his/her nominee not below the rank of Forester-I. - Member Secretary

The Committee shall elect a chairman who shall also be the Honorary Wildlife Warden of the Community Reserve.

SAMPATH KUMAR,

Principal Secretary to the Government of Meghalaya,
Forest & Environment Department.

The 10th March, 2025.

No.FOR.17/2013/Pt-II/331. - In accordance with the provisions of Section 36 C of the Wild Life (Protection) Act, 1972 (as amended up to 2006), the Governor of Meghalaya is pleased to declare Rongdenggre Reserve in West Garo Hills District as a Community Reserve to be known as the "**Rongdenggre Community Reserve**" with immediate effect as per the schedule of boundaries indicated below:-

Schedule of Boundaries:-

The boundary starts from **Point No. 1** at 25°57 ' 41.77", 90°22 ' 28.63", having Arecanut plantation of Manela Sangma on the left, then it proceeds in a North East direction to **Point No. 2** at 25°57 ' 42.73", 90°22 ' 29.54", having Arecanut plantation of Manela Sangma on the left, then it proceeds in a North East direction to **Point No. 3** at 25°57 ' 43.45", 90°22 ' 31.07", having Arecanut plantation of Manela Sangma on the left, then proceeds further in a North East direction till it reaches **Point No. 4** at 25°57 ' 44.15", 90°22 ' 32.48", having Arecanut plantation of Sikman Sangma on the left., then it proceeds in a North East direction to **Point No. 5** at 25°57 ' 44.3", 90°22' 34.05", having Arecanut plantation of Sikman Sangma on the left. From the **Point No. 5**, the boundary proceeds in a South East direction till it reaches **Point No. 6** at 25°57 ' 43.82", 90°22 ' 35.33 ", having Arecanut plantation of Elbinath Sangma on the left., then it proceeds in a South East direction till it reaches **Point No. 7** at 25°57' 43.14", 90°22 ' 36.85", having Arecanut plantation of Elbinath Sangma on the left., then it further proceeds in a North West direction till it reaches **Point No. 8** at 25°57 ' 43.21", 90°22' 35.73", having Arecanut plantation of Mijak Sangma on the left. From the **Point No. 8**, the boundary proceeds in a South West direction upto **Point No. 9** at 25°57 ' 42.66", 90°22 ' 35.17", having Arecanut plantation of Mijak Sangma on the left., then it proceeds in a South East direction till it reaches **Point No. 10** at 25°57 ' 42.04", 90°22 ' 36.63", having Arecanut plantation of Mijak Sangma on the left.

From there it proceeds in a South East direction till it reaches **Point No. 11** at 25°57' 41.04", 90°22 ' 37.51", having Arecanut plantation of Manela Sangma on the left, and then it proceeds in a South West direction till **Point No. 12** at 25°57 ' 39.69", 90°22 ' 36.68", having Arecanut plantation of Manela Sangma on the left, then it proceeds in a South West direction to **Point No. 13** at 25°57 ' 38.35", 90°22 ' 35.73", having Arecanut plantation of Manela Sangma on the left., then proceeds further in a South West direction till it reaches **Point No. 14** at 25°57 ' 37.62", 90°22 ' 34.27", having Arecanut plantation of Manela Sangma on the left, then it proceeds in a South West direction to **Point No. 15** at 25°57' 37.55", 90°22 ' 32.65", having Arecanut plantation of Dingnang Marak on the left. From the Point No. 15, the boundary proceeds in a North West direction till it reaches **Point No.16** at 25°57' 38.42", 90°22 ' 31.47", having Arecanut plantation of Dingnang Marak on the left., then it proceeds in a North West direction till it reaches **Point No. 17** at 25°57 ' 39.77", 90°22 ' 30.72", having Arecanut plantation of Dingnang Marak on the left, then it further proceeds in a North West direction till it reaches **Point No, 18** at 25°57 ' 40.22", 90°22 ' 30.48", having Arecanut plantation of Dingnang Marak on the left. From the **Point No. 18**, the boundary proceeds in a South East direction upto **Point No. 19** at 25°57 ' 39.05", 90°22 ' 30.5", having Arecanut plantation of Nimela Sangma on the left, then it proceeds in a North West direction till it reaches **Point No. 20** at 25°57 ' 40.11", 90°22 ' 29.4", having Arecanut plantation of Nimela Sangma on the left.

AREA: 3.42 hac. (Approximately).

No.FOR.17/2013/Pt-II/331-A. -In exercise of the powers conferred under Section 36 D of the Wild Life (Protection) Act, 1972 (as amended upto 2006), the Governor of Meghalaya is pleased to constitute the Management Committee for the "**Rongdenggre Community Reserve**" consisting of the following members:-

- | | | |
|--|---|------------------|
| 1. Shri Rohith Sangma | - | Chairman |
| 2. Shri Elbinath K. Sangma | - | Member |
| 3. Shri Maten Marak | - | Member |
| 4. Shri Dingnang | - | Member |
| 5. Shri Jekimbirth Marak | - | Member |
| 6. The Divisional Forest Officer, East and West Garo Hills, Wildlife Division, | - | Member Secretary |

Tura or his/her nominee not below the rank of Forester-I.

The Committee shall elect a chairman who shall also be the Honorary Wildlife Warden of the Community Reserve.

SAMPATH KUMAR,

Principal Secretary to the Government of Meghalaya,
Forest & Environment Department.

The 10th March, 2025.

No.FOR.17/2013/Pt-II/332. - In accordance with the provisions of Section 36 C of the Wild Life (Protection) Act, 1972 (as amended up to 2006), the Governor of Meghalaya is pleased to declare Rongdenggre Reserve in West Garo Hills District as a Community Reserve to be known as the "**Rongdenggre Community Reserve**" with immediate effect as per the schedule of boundaries indicated below:-

Schedule of Boundaries:-

The boundary starts from **Point No. 1** at 25°57 ' 40.79", 90°22 '28.17", having Arecanut of Mr. Mijak Sangma, then it proceeds in a South East direction to **Point No. 2** at 25°57 ' 40.11", 90°22 ' 29.1", having Arecanut of Mr. Mijak Sangma, then it proceeds in a South East direction to **Point No. 3** at 25°57 ' 39.46", 90°22 ' 30.08", having Arecanut of Mr. Mijak Sangma, then proceeds further in a South West direction till it reaches **Point No. 4** at 25°57 ' 38.32", 90°22 ' 29.74", having Arecanut of Mr. Mijak Sangma, then it proceeds in a South West direction to **Point No. 5** at 25°57 ' 37.36", 90°22 ' 29", having Arecanut of Mr. Mijak Sangma. From the **Point No. 5**, the boundary proceeds in a North West direction till it reaches **Point No. 6** at 25°57 ' 37.39", 90°22 ' 27.69", having Arecanut of Mr. Mijak Sangma, then it proceeds in a North West direction till it reaches **Point No. 7** at 25°57 ' 37.92", 90°22' 26.63", having Arecanut of Mr. Mijak Sangma, then it further proceeds in a North West direction till it reaches **Point No. 8** at 25°57 ' 38.24", 90°22 ' 25.41", having Arecanut of Mr. Arjun Marak. From the **Point No. 8**, the boundary proceeds in a North West direction upto **Point No. 9** at 25°57 ' 38.53", 90°22 ' 24.12", having Arecanut of Mr. Arjun Marak, then it proceeds in a North West direction till it reaches **Point No. 10** at 25°57 ' 38.67", 90°22 ' 22.96", having Arecanut of Mr. Arjun Marak.

From there it proceeds in a South West direction till it reaches **Point No. 11** at 25°57 ' 38.6", 90°22 ' 21.68", having Arecanut of Mr. Arjun Marak and then it proceeds in a North West direction till **Point No. 12** at 25°57 ' 38.91", 90°22 ' 20.64", having Arecanut of Mr. Arjun Marak, then it proceeds in a North West direction to **Point No. 13** at 25°57 ' 39.88", 90°22 ' 20.02", having Arecanut of Mr. Arjun Marak, then proceeds further in a North East direction till it reaches **Point No. 14** at 25°57 ' 40.37", 90°22 ' 21.08", having Arecanut of Mr. Arjun Marak, then it proceeds in a North East direction to **Point No. 15** at 25°57 ' 41.22", 90°22 ' 21.94", having Arecanut of Mr. Dingnang Marak. From the **Point No. 15**, the boundary proceeds in a North East direction till it reaches **Point No.16** at 25°57 ' 41.81", 90°22 ' 23.02", having Arecanut of Mr. Dingnang Marak, then it proceeds in a North East direction till it reaches **Point No. 17** at 25°57 ' 42.78 ", 90°22 ' 23.7", having Arecanut of Mr. Dingnang Marak, then it further proceeds in a North East direction till it reaches **Point No. 18** at 25°57 ' 43.11", 90°22 ' 24.83", having Arecanut of Mr. Dingnang Marak. From the **Point No. 18**, the boundary proceeds in a South East direction upto **Point No. 19** at 25°57 ' 42.57", 90°22 ' 26.02", having Arecanut and Rubber of Mr. Satnang Marak, then it proceeds in a South East direction till it reaches **Point No. 20** at 25°57 ' 42.07", 90°22 ' 27.19", having Arecanut and Rubber of Mr. Satnang Marak.

AREA: 2.89 hac. (Approximately).

No.FOR.17/2013/Pt-II/332-A. - In exercise of the powers conferred under Section 36 D of the Wild Life (Protection) Act, 1972 (as amended upto 2006), the Governor of Meghalaya is pleased to constitute the Management Committee for the "**Rongdenggre Community Reserve**" consisting of the following members:-

- | | | | |
|----|---|---|------------------|
| 1. | Shri Rohith Sangma | - | Chairman |
| 2. | Shri Elbinath K. Sangma | - | Member |
| 3. | Shri Maten Marak | - | Member |
| 4. | Shri Dingnang | - | Member |
| 5. | Shri Jekimbirth Marak | - | Member |
| 6. | The Divisional Forest Officer, East and West Garo Hills, Wildlife Division, Tura or his/her nominee not below the rank of Forester-I. | - | Member Secretary |

The Committee shall elect a chairman who shall also be the Honorary Wildlife Warden of the Community Reserve.

SAMPATH KUMAR,

Principal Secretary to the Government of Meghalaya,
Forest & Environment Department.

The 10th March, 2025.

No.FOR.17/2013/Pt-II/333. - In accordance with the provisions of Section 36 C of the Wild Life (Protection) Act, 1972 (as amended up to 2006), the Governor of Meghalaya is pleased to declare Bolchu A-dingre Reserve in West Garo Hills District as a Community Reserve to be known as the "**Bolchu A-dingre Community Reserve**" with immediate effect as per the schedule of boundaries indicated below:-

Schedule of Boundaries:-

The boundary starts from **Point No. 1** at 25°54 ' 38.79", 90°22 ' 57.61", having Arecanut plantation of Mrs. Robina Sangma on the left, then it proceeds in a South East direction to **Point No. 2** at 25°54 ' 38", 90°22 ' 59.31", having Arecanut plantation of Mrs. Robina Sangma on the left, then it proceeds in a South East direction to **Point No. 3** at 25°54 ' 37.02", 90°23 ' 0.99", having Arecanut plantation of Mrs. Robina Sangma on the left., then proceeds further in a South East direction till it reaches **Point No. 4** at 25°54 ' 36.14", 90°23 ' 1.3", having Areca nut plantation of Mrs. Amina Sangma on the left., then it proceeds in a South West direction to **Point No. 5** at 25°54 ' 34.5", 90°23 ' 0.48", having Arecanut plantation of Mrs. Amina Sangma on the left.. From the **Point No. 5**, the boundary proceeds in a South West direction till it reaches **Point No.6** at 25°54 ' 34.42", 90°22 ' 58.53", having Arecanut plantation of Mrs. Amina Sangma on the left, then it proceeds in a South West direction till it reaches **Point No. 7** at 25°54 ' 33.21", 90°22 ' 57.71", having Arecanut plantation of Mrs. Amina Sangma on the left, then it further proceeds in a South East direction till it reaches **Point No. 8** at 25°54 ' **31.38**", 90°22 ' 57.96", having Areca nut plantation of Mrs. Amina Sangma on the left. From the **Point No. 8**, the boundary proceeds in a South West direction upto **Point No. 9** at 25°54 ' 30.51", 90°22 ' 56.52", having Arecanut plantation of Mrs. Amina Sangma on the left., then it proceeds in a South West direction till it reaches **Point No. 10** at 25°54' 28.94", 90°22 ' 55.77", having Arecanut plantation of Mrs. Amina Sangma on the left.

From there it proceeds in a South West direction till it reaches **Point No. 11** at 25°54 ' 27.82", 90°22 ' 54.68", having Arecanut plantation of Bahanangre Village on the left, and then it proceeds in a South West direction till **Point No. 12** at 25°54 ' 27.49", 90°22 ' 52.79", having Arecanut plantation of Bahanangre Village on the left, then it proceeds in a North West direction to **Point No. 13** at 25°54 ' 27.81", 90°22 ' 51.26", having Arecanut plantation of Bahanangre Village on the left, then proceeds further in a North West direction till it reaches **Point No. 14** at 25°54 ' 29.09", 90°22 ' 50.2", having Arecanut plantation of Mrs. Jonina Sangma on the left, then it proceeds in a North East direction to **Point No. 15** at 25°54' 30.66", 90°22 ' 50.58", having Arecanut plantation of Mrs. Jonina Sangma on the left. From the **Point No. 15**, the boundary proceeds in a North East direction till it reaches **Point No.16** at 25°54 ' 32.01", 90°22 ' 51.93", having Areca nut plantation of Mr. Kimnan Marak on the left., then it proceeds in a North East direction till it reaches **Point No. 17** at 25°54 ' 33.25", 90°22 ' 53.45", having Arecanut plantation of Mr. Kimnan Marak on the left, then it further proceeds in a North East direction till it reaches **Point No. 18** at 25°54 ' 34.51", 90°22 ' 54.52", having Rubber plantation of Mr. Kimnan Marak on the left. From the **Point No. 18**, the boundary proceeds in a North East direction upto **Point No. 19** at 25°54 ' 35.62", 90°22 '56.06", having Arecanut plantation of Bolchugre Baptist Church on the left, then it proceeds in a North East direction till it reaches **Point No. 20** at 25°54 ' 37", 90°22 ' 56.49", having Arecanut plantation of Bolchugre Baptist Church on the left.

AREA: 4.71 hac. (Approximately).

No.FOR.17/2013/Pt-II/333-A. - In exercise of the powers conferred under Section 36 D of the Wild Life (Protection) Act, 1972 (as amended upto 2006), the Governor of Meghalaya is pleased to constitute the Management Committee for the "**Bolchu A'dingre Community Reserve**" consisting of the following members:-

- | | |
|--|--------------------|
| 1. Shri Pribalson Ch. Marak | - Chairman |
| 2. Shri Billian R. Marak | - Member |
| 3. Shri Rodith A. Sangma | - Member |
| 4. Smti. Hollita B. Marak | - Member |
| 5. Smti. Robina A. Sangma | - Member |
| 6. The Divisional Forest Officer, East and West Garo Hills, Wildlife Division, | - Member Secretary |

Tura or his/her nominee not below the rank of Forester-I.

The Committee shall elect a Chairman who shall also be the Honorary Wildlife Warden of the Community Reserve.

SAMPATH KUMAR,

Principal Secretary to the Government of Meghalaya,
Forest & Environment Department.

The 10th March, 2025.

No.F(PR)-76/2009/Pt.III/309.

Subject:- Assured Career Progression Scheme (ACPS) for the State Government Employees.

It has come to the notice of this Department that some Departments/Directorates/Offices have confirmed the adhoc services of employees without regularisation and such employees have also been granted financial up-gradation(s) under the Assured Career Progression Scheme. It may be clarified that adhoc service/appointment should not be confirmed without regularisation through due procedure and approval of Personnel & A.R.(B) Department.

Para. 2(3) of O.M. No.F(PR)-76/2009/54, dated 22nd February, 2010 clearly states that **"Casual Workers (including those with temporary status or those conferred with Regular Casual Worker status) and employees appointed under adhoc basis, Regulation 3(f) and contract service shall not be eligible for the benefits under the Scheme"**.

It is hereby reiterated that adhoc service cannot be counted for the purpose of financial benefit under the ACP/MACP Scheme. In such cases, counting of regular service will start from the date of regularisation.

The contents of this letter may be brought to the notice of all District/Subordinate Offices under your control.

VIJAY KUMAR D.,

Commissioner & Secretary to the Govt. of Meghalaya,
Finance (Pay Revision) Department.

The 29th March, 2025.

No.TPT.90/2024/261. - The Governor of Meghalaya is pleased to notify the District Rural Development Agency (DRDA), Ri-Bhoi District, Nongpoh, as the Nodal Agency for Direct Purchase of Land to the proposed expansion of Runway-04 and the Isolation Bay of the Shillong Airport, Umroi for the 16 Acres and 6 acres.

The notified Nodal Agency, after completing all the formalities, will hand over the purchased land to the Transport Department for the Shillong Airport expansion.

D. D. SANGMA,

Secretary to the Govt. of Meghalaya,
Transport Department.

The 28th February, 2025.

No.EDN.20/2001/Pt/556. - The National Council for Teacher Education (NCTE) has developed the following two national documents aligned with NEP 2020 for ensuring quality in teacher education system in the Country and thereby enhancing the learning outcomes of students:-

- i. **National Professional Standards for Teachers (NPST) Guiding Documents (para 5.20, NEP 2020):**
This document is public statement developed by Government of India in the form of a set of standards that constitute teacher quality and desired requirements in teacher to improve the learning outcomes of students.
- ii. **National Mission for Mentoring (NMM) - The Bluebook (para 15.11, NEP 2020):** This document aims to provide mentorship support to all school teachers in India and create a network of mentor who will support and empower the teachers (mentees) to improve their teaching practices and enhance their overall professional growth and development.

Accordingly, the Governor of Meghalaya is pleased to nominate **Shri P. B. Lartang, Deputy Director, Directorate of Educational Research & Training as Nodal Officer** to represent the State as Key Resource Person (**KRP-NPST/NMM**).

The details of the Nodal Officer is as per format enclosed.

R. R. RAPTHAP,
Commissioner & Secretary to the Govt. of Meghalaya,
Education Department.

FORMAT
Nodal Officer (NPST/NMM)

Name of the State/UT : MEGHALAYA	
Sl. No.	National Professional Standards for Teachers (NPST) & National Mission for Mentoring (NMM)
1.	Name & Designation :- Shri P. B. Lartang, Deputy Director, Directorate of Educational Research & Training, Shillong.
Contact Details	
2.	Address (Office):- Directorate of Educational Research & Training Laitumkhrah, Nongrimmaw, Shillong-793011. Email Id (Personal/Office) : Phone/Mobile : 9436335591.

Signature

(Name & Designation)
Authorized Signatory.

The 28th March, 2025.

No.FEM.56/2016/103. - In continuation to this Department's Notification No.FEM.56/2016/99, dated 13th February, 2025, the following rate of Mileage Allowance shall be added with immediate effect:

Sl. No.	Engine Capacity	Class of Vehicles	Allotted Vehicles		Own Vehicles in respect of Grade I & II Govt. Employees	
			Age of Vehicles 0-4 Years	Age of Vehicles Above 4 Years	Age of Vehicles 0-4 Years	Age of Vehicles above 4 Years
PETROL Vehicle by make						
1.	1.0 L - 1.2 L	Nissan Magnite	8.00	9.00	9.00	12.00

VIJAY KUMAR D.,

Commissioner & Secretary to the Government of Meghalaya,
Finance Department.

The 29th March, 2025.

No.PER (AR) 94/2023/43. - In supersession of the notification No.PER(AR)94/2024/1, dated 1st November, 2023 & No.PER(AR)94/2024/20, dated 21st March, 2024 the sitting fees for the members of the Expert Committee has been enhanced from ₹ 15,000/- (Rupees fifteen thousand) to ₹ 25,000/- (Rupees twenty five thousand) only per day from the date of taking charge.

C. V. D. DIENGDOH,

Commissioner & Secretary to the Govt. of Meghalaya,
Personnel and Administrative Reforms (B) Department.

The 1st April, 2025.

No.PER (ARC) 15/2024/20. - In continuation to this Department's Notification No.PER(ARC)14/2022/106, dated 17th March, 2025 the entry at Sl. No. 203 shall be added to the List of Services notified under Section 3(2) of The Meghalaya Right to Public Services Act, 2020, with effect from the date of issue of the notification.

Sl. No.	Name of Service	Number of working days for service delivery after receipt of applications	Department/ Organizations	Designated Official	Appellate Authority
203.	Registration/Renewal under Plastic waste management Rules 2016 for manufacturer	90 days	Meghalaya State Pollution Control Board	Member Secretary	Chairman

C. V. D. DIENGDOH,

Commissioner & Secretary to the Government of Meghalaya,
Personnel & Administrative Reforms (B) Department
(Administrative Reforms Cell).

The 27th March, 2025.

No.UAU.49/2020/Pt.III/72. - The Governor of Meghalaya is pleased to notify the New Shillong Township Development Agency (NSTDA) to acquire an additional 50 acres of land at Lumdiengsai, Shnat Raid Tynring, for the further development of New Shillong City.

The map of the acquired plot with East border with Raid Mawpdang, West border with Shnat Raid Tynring, North border with Shnat Raid Tynring, South border with Shnat Raid Tynring, and P.W.D. Road passing through the plot is attached in Annexure-I.

VIJAY KUMAR D,

Commissioner and Secretary to the Govt. of Meghalaya,
Urban Affairs Department.

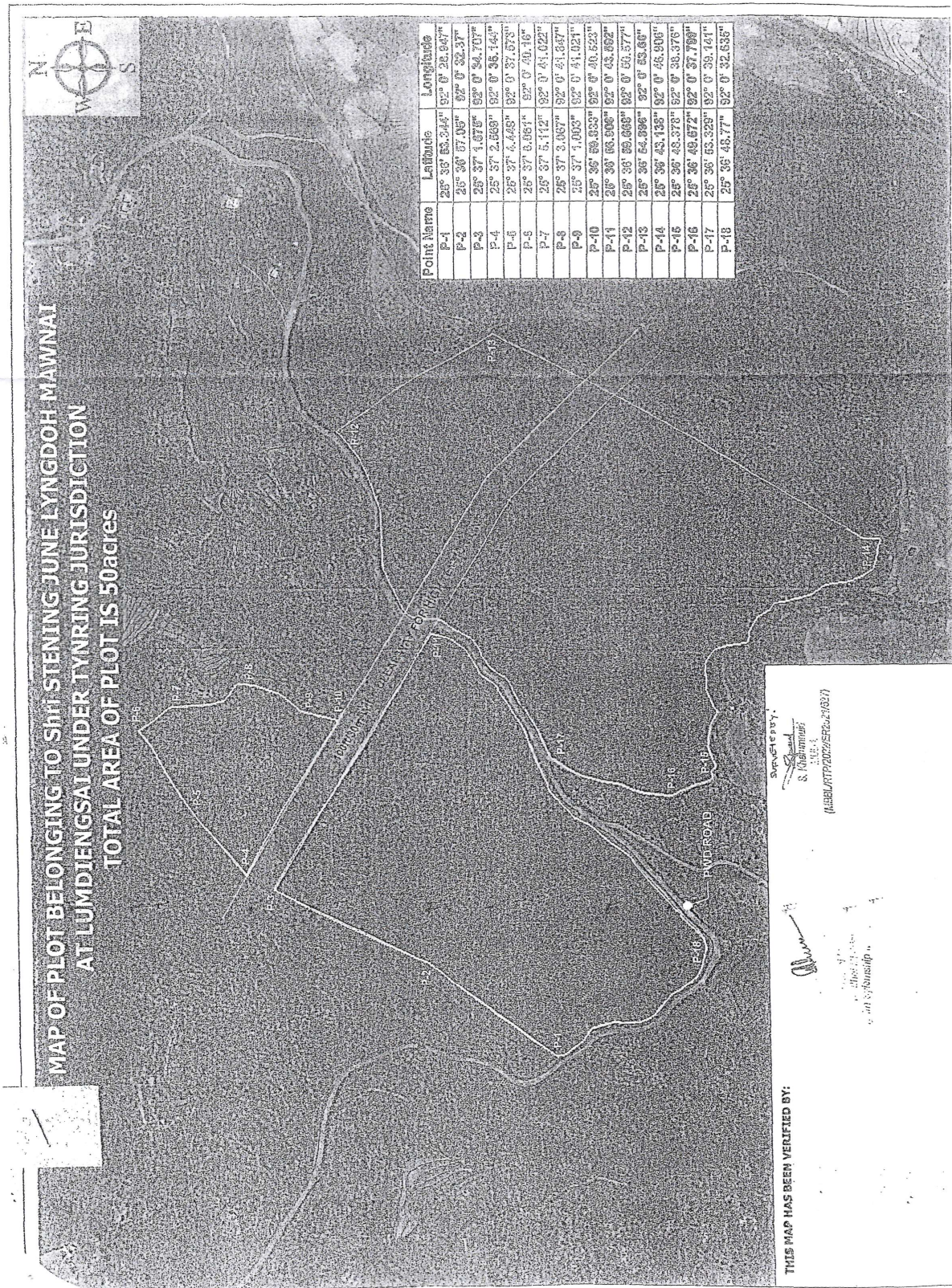

The 2nd April, 2025.

No.DCA.68/2012/82.

NO.DC.XIV(E)1/2005-2024/22/

Dated Shillong the _____, 2024

THE UNITED KHASI-JAINTIA HILLS AUTONOMOUS DISTRICT (MANAGEMENT AND CONTROL OF FOREST-RATES OF ROYALTY) (AMENDMENT) RULES, 2024.

Preamble: Whereas it is expedient to further amend the United Khasi-Jaintia Hills Autonomous District (Management and Control of Forest-Rates of Royalty) Rules, 2005, hereinafter referred to as the 'Principal Rules'

Now, therefore, in exercise of the power conferred on it under Section 34 read with Section 8 of the United Khasi-Jaintia Hills Autonomous District (Management and Control of Forests) Act, 1958, as amended, and all other powers enabling it in that behalf, the Executive Committee, Khasi Hills Autonomous District Council is pleased to make the following Rules to amend the Principal Rules, as indicated below: -

1. **Short title, Extent and Commencement:-** (i) These Rules shall be called the United Khasi-Jaintia Hills Autonomous District (Management and Control of Forest-Rates of Royalty) (Amendment) Rules, 2023.
(ii) They shall apply to the whole of the Khasi Hills Autonomous District Council.
(iii) They shall come into force with effect from 1st August, 2023.
2. **Amendment of Schedule of rates under Rule 2B:** The entire Schedule of rate under Rule 2B shall be deleted and substituted by the following:-

B. (i) RATES OF ROYALTY ON LOGS PER CUM (Cubic metre)

<u>CLASSES</u>	<u>MIDGIRTH (0.61 m to 1.22 m)</u>	<u>MIDGIRTH (above 1.22 m)</u>
Special	Rs.	Rs.
Teak	1450.00	1685.00
Carpinus (For all size)	1685.00	1685.00
I	220.00	350.00
II	140.00	250.00
III	120.00	200.00
IV	90.00	150.00
V	80.00	120.00

NOTE:

- (i) The cubic contents of the log will be calculated by multiplying the square of the quarter girth taken at the middle of the log (under bark). For logs above 3.65 metres in length the girth will be measured at 1.83 metres from the butt end of the log.
- (ii) Rates for sawn timber shall be double the rate mentioned under girth 1.22 metres and above irrespective of the girth of the log from which the sawn timber has been converted.
- (iii) Payment of royalty at log rates will enable the purchaser to remove slabs obtained on conversion without further payment. Payment at sawn a timber rates after conversion in the forests will not enable the purchaser to remove slabs, and the royalty on them shall leviable separately as prescribed.

B. (ii) RATE FOR MINOR FOREST PRODUCTS**Royalty in full**

	<u>Rs. P</u>	<u>Per Quintal</u>
1. Tezpatta	50.00	"
2. Wild Pepper	250.00	"
3. Broomstick	100.00	"
4. Pine Dhup wood	25.00	"
5. Firewood	100.00	Per stack of 1m X 2 m
6. Split Firewood	5.00	Per bundle of 0.45 metre in circumference

Royalty in full

	<u>Rs. P</u>	<u>Per Kg</u>
7. Agar Wood		
Class – I	600.00	"
Class – II	500.00	"
Class – III	220.00	"
Class – IV	20.00	"
8. Wood Lichen	100.00	Per Quintal
9. Sohpairah (ritha)	120.00	"
10. Topchini	150.00	"
11. Mujit (Jyrmi Khlaw)	250.00	"
12. Stone lichen	350.00	"
13. Jalawan Powder (latyrthia leaves & snepdieng)	200.00	"
14. Latyrthia Leaves	150.00	"
15. Gonsana	200.00	"
16. Firewood Bamboo	5.00	Per Bundle of 0.60 m in dia
17. Thatch Grass	30.00	Per 100 Bundles of 10 cm in dia
18. Fodder Grass	10.00	Per Head load
19. Pine Cone	75.00	Per Quintal

B. (iii) Rate for Bamboos

	<u>Royalty in full</u>	<u>Per 100 Numbers</u>
1. Dendrocalamus hamiltonii	150.00	"
2. Bamboosa Tulda (Jati)	120.00	"
3. Bamboos Palade (makal)	150.00	"
4. Bamboosa bulgaris (bariala)	200.00	"
5. Bamboosa balcoon (bhaluka)	200.00	"
6. Melocanna Bambooscides (muli)	100.00	"
7. Dendrocalamus strictus (male calabua)	100.00	"
8. Pseudesteichium polymarphum	100.00	"
9. Theinestachyum dalua (dalu)	100.00	"
a. Other bamboos of 5cm and above	100.00	"
b. Other bamboos of 2.5 to 5 cm in diameter	100.00	"
c. Other bamboos less than 2.5 cm in diameter	100.00	"

B. (iv) Rate for canes

	<u>Royalty in full</u>	<u>Per Quintal</u>
1. Calamus liptospadix	Rs. 100.00	"
2. Calamus floribundus (ligari, Riphin)	Rs. 100.00	"
3. Calamus species (kdait)	Rs. 100.00	"

Roofing Leaves (Tynriew)

1. Toko	100.00	Per 1000 leaves
2. Jeng and others	100.00	Per 1000 leaves

- B. (v) All other minor forest produces not listed above like honey, lac, solonum berries, bee wax, sakunmatara, rauwalfia serpentine, chalamghra etc., will be charge at 10% *ad volarem*.

By Order etc.

PYNIAD SING SYIEM,
Chief Executive Member
Khasi Hills Autonomous District Council,
Shillong.